

# Large Headless Screw™

Surgical Technique | *TriMed Cannulated Screw System™*

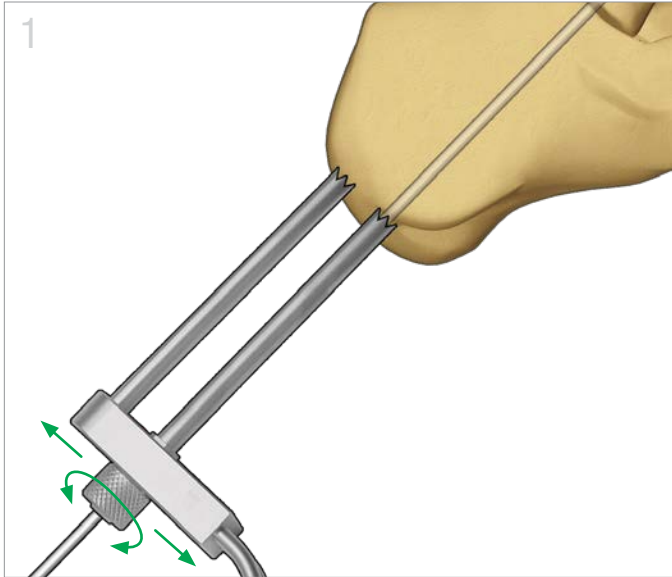

## Insert Guide Wire

- Select desired distance on Parallel K-wire Sleeve and adjust the movable sleeve to the desired position.
- Tighten the lock nut on the adjustable sleeve to secure its location.
- Insert appropriately sized K-wire(s) to desired depth.

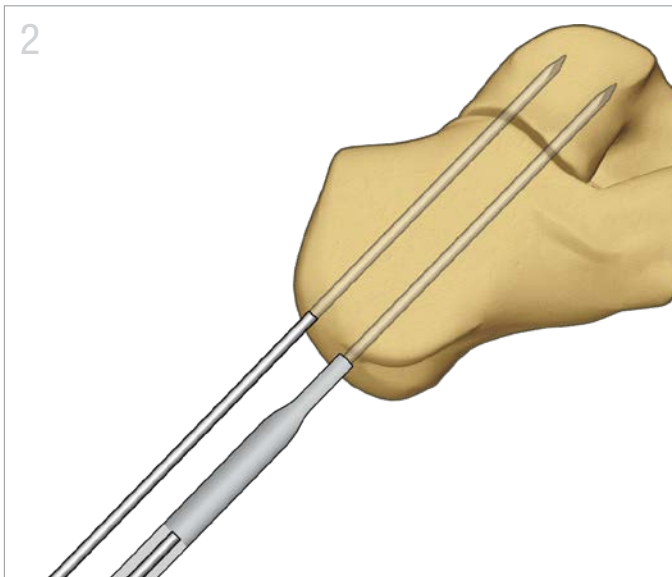

## Measure Depth

- Measure K-wire depth with Wire Gauge.
- When possible, advance K-wire beyond intended screw length to prevent K-wire from being extracted with drill.

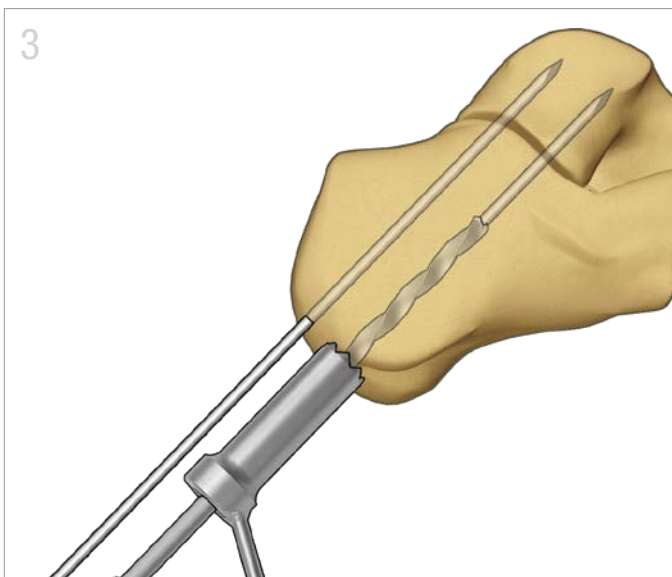

## Drill Hole

- Place Tissue Protector.
- Drill to desired depth. Confirm with C-arm.
- Use corresponding sized Countersink.

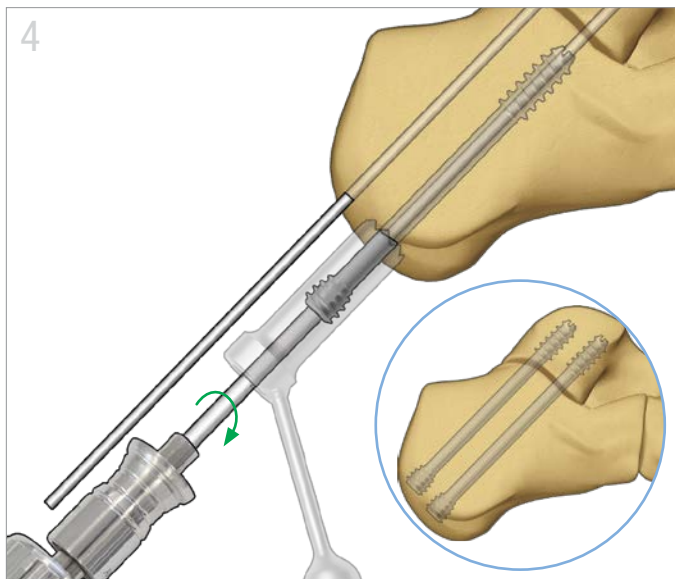

## Insert Screw

- Select appropriate screw length and drive screw until flush with bone.
- Remove K-wire.
- Repeat the previous steps for additional screw placement.

## TIPS



- Inserting screws by hand is recommended as power driven screws can lead to increased heat generation.
- Avoid applying too much torque, which can damage the screw head and/or driver.

# Large Headless Screw

All implants made from surgical grade stainless steel

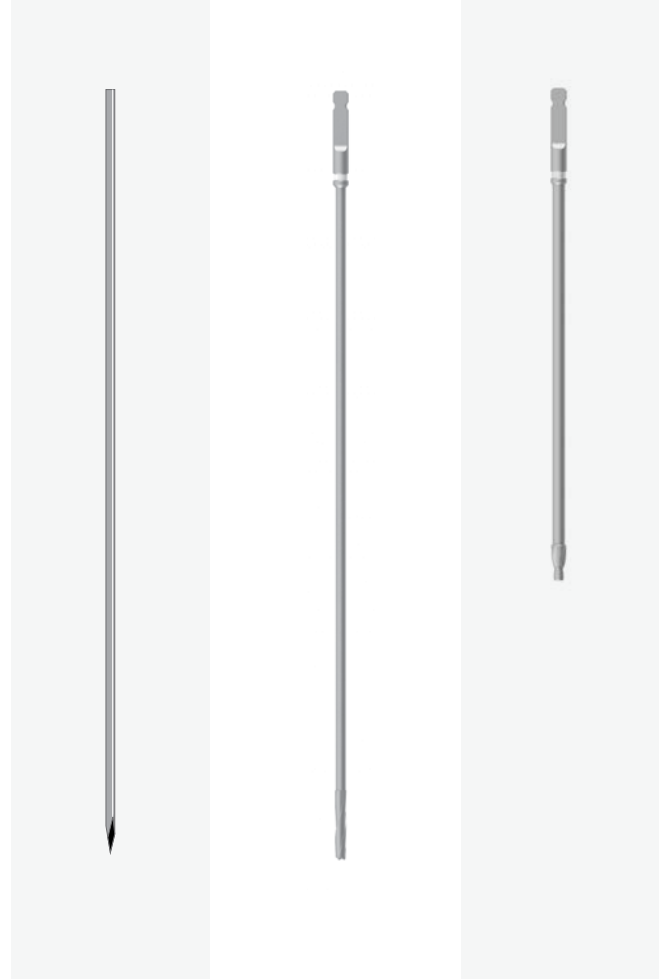
Screws shown at actual size:



Screw	Length*	Thread	Head	Parallel K-wire Guide	K-wire	Drill	Countersink
<b>4.5</b> S45xx 	26-44mm* 44-64mm**	4.5mm	5.5mm	GUIDEP-2.5/2.5	WIRE-1.6/230	DRILL-3.2/220C	HSINK-4.5
<b>5.5</b> S55xx L55xx 	26-44mm* 44-64mm**	5.5mm	6.7mm	GUIDEP-2.5/2.5	WIRE-2.0/230	DRILL-4.0/220C	HSINK-5.5
<b>7.3</b> S73xx L73xx 	44-112mm**	7.3mm	8.5mm	GUIDEP-2.5/2.5	WIRE-2.5/230	DRILL-5.1/220C	HSINK-7.3

\*2mm Increments available

\*\*4mm Increments available  
Long threads available in select lengths



TriMed, Inc. / 27533 Avenue Hopkins / Santa Clarita, CA 91355 USA / 800-633-7221 / [www.trimedortho.com](http://www.trimedortho.com)

The technique presented is one suggested surgical technique. The decision to use a specific implant and the surgical technique must be based on sound medical judgment by the surgeon that takes into consideration factors such as the circumstances and configuration of the injury.

This document is controlled by TriMed, Inc. When downloaded, printed, and/or copied, this document becomes uncontrolled, and users should always check [trimedortho.com](http://trimedortho.com) for the latest version.

For indications, contraindications, warnings and precautions related to TriMed Large Headless Screw reference IFU on [trimedortho.com/ifu](http://trimedortho.com/ifu).

See [trimedortho.com/patents](http://trimedortho.com/patents) for all patent information.

