

Forearm Plate

Elbow & Forearm System

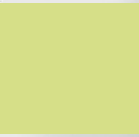

SURGICAL TECHNIQUE

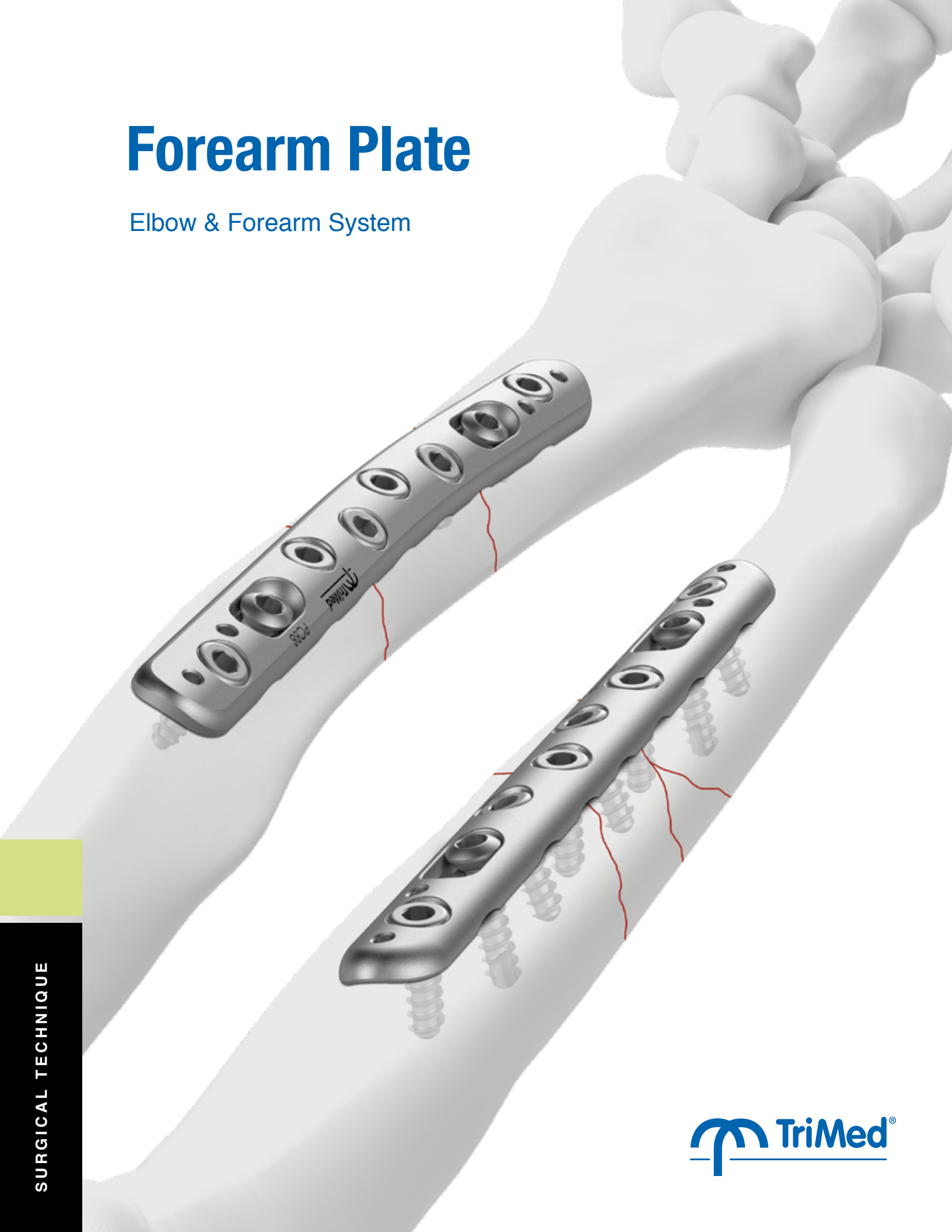

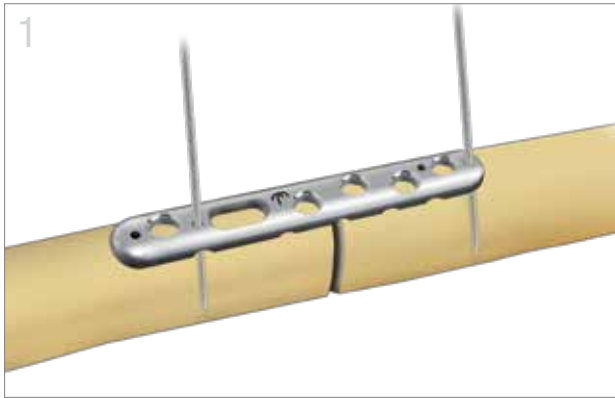
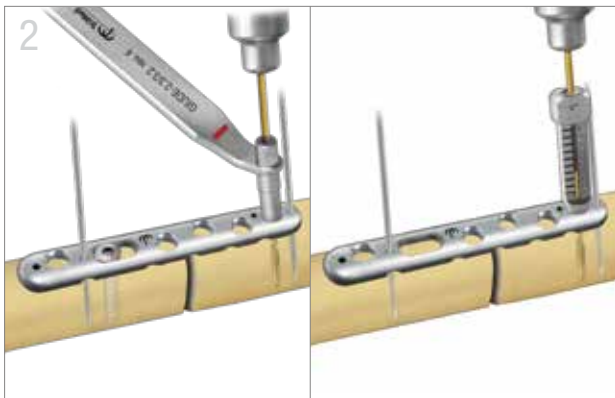

Plate Placement

- Place the plate on bone utilizing provisional K-wires, if appropriate.



Screw Insertion

- To utilize a non-locking cortical screw, use GUIDE-2.3/3.2 (red) and a long 2.3mm (red) drill.
- To utilize a locking cortical screw, use GUIDELCBS-2.3 and a long 2.3mm (red) drill.

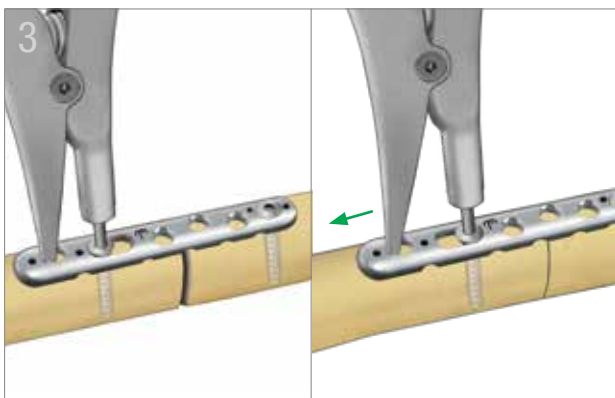

Compression

- Fasten the plate with a screw on the side of the fracture away from the slotted hole. On the other side of the fracture, place a cortical screw in the slotted hole. Do not completely tighten this screw.
- Engage screwdriver tip of the Expander/Compression tool into the screw in the slotted hole. Insert the tool's jaw into the adjacent screw hole away from the fracture line.
- Gently squeeze handle to compress fracture. Tighten screw in slotted hole.



Final Fixation

- Complete fixation with additional screws.

All implants made from surgical grade stainless steel